

# bead chain necklace

you will need the following supplies:

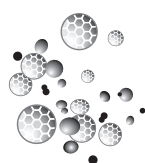

beads



clasp



wire



wire cutters

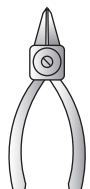

needle nose pliers



cone nose pliers

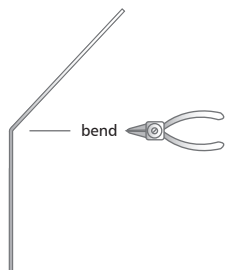

**Step 1:** With your wire cutters, cut off a 2-inch piece of wire (length will depend on bead size). At, approximately the middle of the wire, bend a 90-degree angle with your needle nose pliers.

**Step 2:** Grip the wire 1/4" from the top of the bend with your cone nose pliers, begin to bend the wire forward until a loop is formed.

**Step 3:** Add your clasp by feeding the looped end tail through the hole of the clasp, slide it up until it clicks into place.

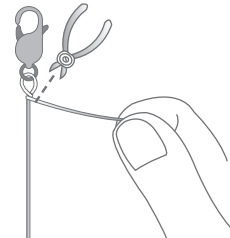
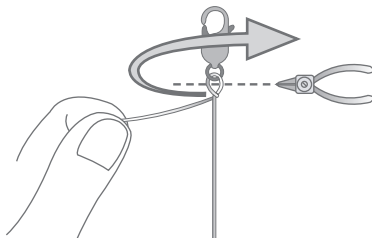
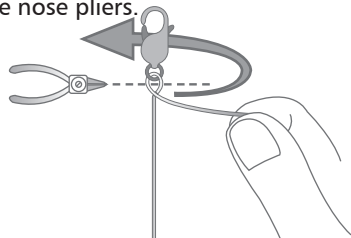

**Step 4:** Grip the top portion of the loop with your needle nose pliers to hold the loop in place. Wrap the tail around the neck of the loop with your fingers.

**Step 5:** Wrap at least 1.5 times around the neck.

**Step 6:** Cut off the excess tail as closely as possible to prevent sharp bits from poking out.

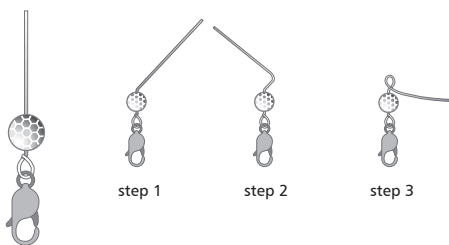

step 1

step 2

step 3

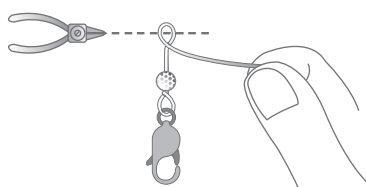

**Step 7:** Add a bead and repeat steps 1-3 with the exception of attaching the clasp. In this step you will leave the loop empty.

**Step 8:** Grip the loop and wrap the tail of wire around the neck of the loop at least 1.5 times.

**Step 9:** Cut off the excess tail as closely as possible to prevent sharp bits from poking out.

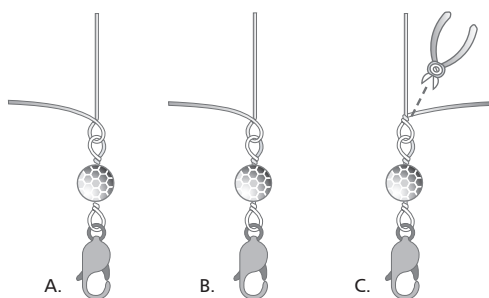

A.

B.

C.

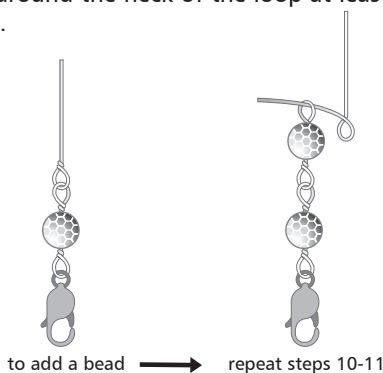

to add a bead

repeat steps 10-11

**Step 10:** Cut off 2" of wire. A) Make a loop at one end. B) Attach the open loop onto the hoop of your previous bead. C) Wrap tail around the neck of the new loop at least 1.5 times. Cut off end.

**Step 11:** Repeat these steps over and over until desired length of necklace has been achieved.

**Step 12:** Once you have achieved the desired length for your necklace, add the other end of your clasp and wrap off end as usual.

instructions by  THE BEADERY.CA

Property of The Beadery do not reproduce or distribute this document in part or whole.